

# AEM12000/AEM12000R Series Magnetic Lock Wiring Instruction

## A. 12VDC Input:

Connect the ground(-) lead from a 12VDC power source to black wire of PCB.  
Connect the positive(+) lead from a 12VDC power source to red wire of PCB.  
Set jumper for 12VDC operation.

## B. 24VDC input:

Connect the ground(-) lead from a 24VDC power source to black wire of PCB.  
Connect the positive(+) lead from a 24VDC power source to red wire of PCB.  
Set jumper for 24VDC operation.

## C. Contacts:

Reed switch dry contacts are rated max 3W(max switching contact 0.25A) at 30VDC/AC for safe operation, Do not exceed this rating.

If you require a normally open switch, connect the wires from the system to black wire and green wire of PCB.

If you require a normally closed switch, connect the wires from the system to black wire and red wire of PCB.

## Important!

If power switch is not wired between DC source voltage and magnet, it will take a longer time to de-energize the magnet simulating residual magnetism (see below)

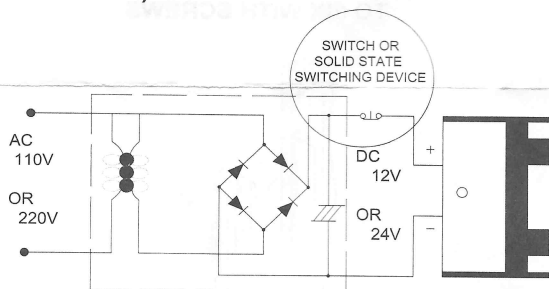

Corrent

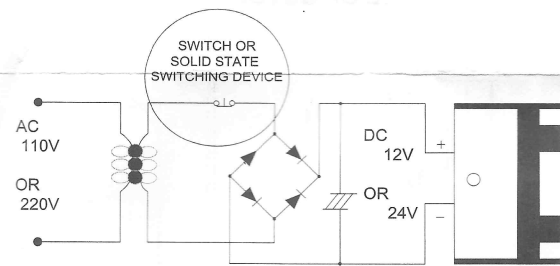

Incorrent

## Printed Circuit Board Schematic

WITH TIMER

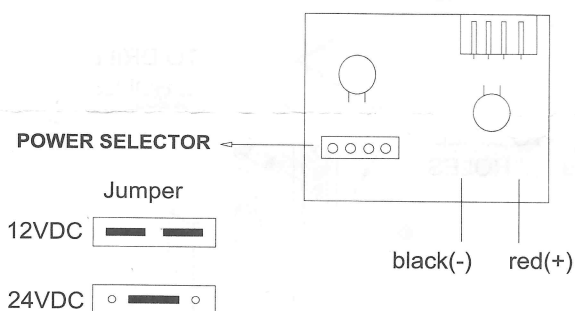

For fire rating on Timber Doors the intumescent seal must be fitted.

Securefast PLC  
6 Cedar Business Centre, Avon Road,  
Cannock, Staffs, England WS11 1QJ  
Tel: +44 (0) 1704 502801

WITH LOCK STATUS  
SENSOR(Reed Sw)

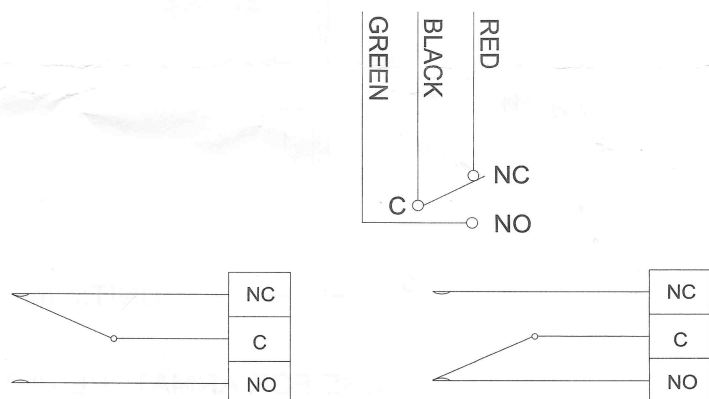

Input voltage too low or insufficient contact between armature and magnet

Armature and magnet are properly aligned

# Important: Please Read Before Attempting To Install Magnetic Lock

- A. Handle the equipment with care, damaging the mating surface of the magnet or armature plate may reduce locking efficiency.
- B. The magnet mounts rigidly to the door frame. The armature plate mounts to the door with hardware. Kit provided that allows it to pivot about its center to compensate for door wear and misalignment.
- C. Template use must take place with the door in its normally closed position.
- D. Before installing please add the thread locker to all screws. Firmly tighten the screws to avoid fastening loosen.

SIZE OF CUTOUT

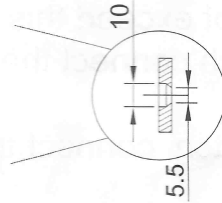
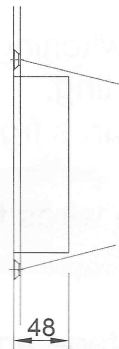
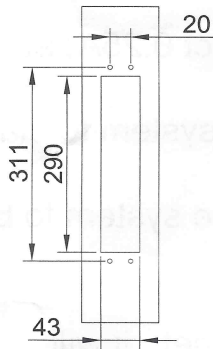

UNIT:mm

USE FOR MAGNET/SLIDING DOOR

TO FIX WITH SCREWS

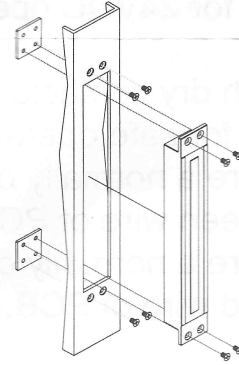

SIZE OF CUTOUT

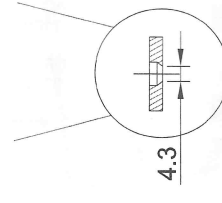
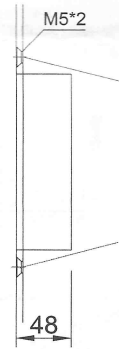
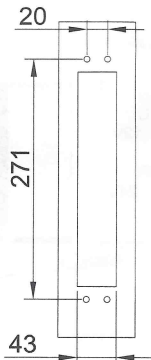

UNIT:mm

USE FOR MAGNET/SLIDING DOOR-W/O MOUNTING PLATE

TO FIX WITH SCREWS

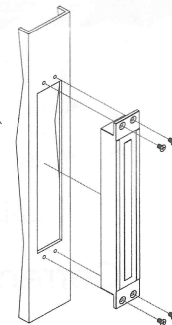

SIZE OF CUTOUT

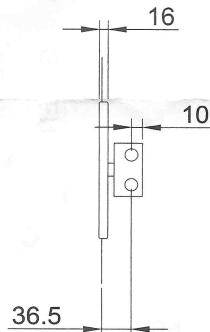
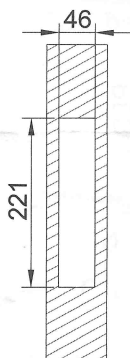

UNIT:mm

USE FOR ARMATURE PLATE/SLIDING DOOR

TO FIX WITH SCREWS

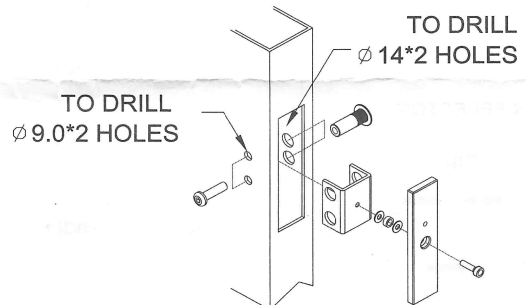

ARMATURE PLATE

**\*\*Important :** Fix the armature plate not too tightly, and make the rubber washer more flexible, in order to make the armature plate automatically adjust its proper position with the magnet.