

ASL941B Range OnDoor Be-Tech MIFARE™ Standalone Lock



The Be-Tech ASL941B is a wire free, standalone battery powered lock using MIFARE™ RFID proximity technology which offers an easy to use and secure access solution ideal for small installations.

The system uses a “Take on Card System” for programming the cards at the door and has a battery warning given when the power is low.

Certification

Fire rated for 60 min. to EN1634-1:2014 on composite timber door.
Intertek Report No. 141222001SHJ-BP-1
Dated 23RD Jan 2015

Certified to EN14846:2008
Classification Code 3-S-5-1-0-J-3-1-2
Intertek Report No. 131014059GZU-001
Dated 14th Oct 2013

CE approved

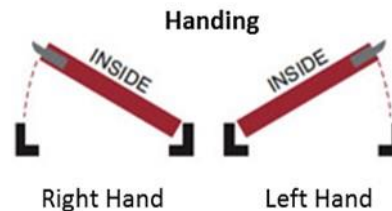

Features & Benefits

- Lock case has 65mm backset with 93.5mm crs
- Each lock will accept 99 User cards per lock
- Simple card invalidation
- ISO printable or pre-printed cards, tokens ,etc.
- Cards can be used for multiple sites and multiple applications
- 3 keys supplied with each lock for key override emergency use from the outside.
- Standard finish Brushed Stainless Steel, other finishes available to special order
- Suitable for timber and metal doors 35 to 50mm thick (Upgrade kits are available for thicker doors)
- Anti-thrust Latch
- Inside handle offers escape function
- Passage mode
- Dedicated cylinder for lock case
- Supplied with 4 standard AA batteries
- No wiring
- Dead bolt for added security thrown on the inside by thumb turn
- Outside Lever Handle free when locked
- Euro and ANSI lock case options

Ideal for:-

Small hotels, residential accommodation and low number installations in universities, colleges, schools, offices, and hospitals.

Code	Description
ASL941B-L	Standalone Lockset (LH) with Safety Lever
ASL941B-R	Standalone Lockset (RH) with Safety Lever
ASL941B-56-L	Standalone Lockset (LH) with Straight Lever
ASL941B-56-R	Standalone Lockset (RH) with Straight Lever
ASL954	Cards /100

ASL941B Range OnDoor Be-Tech MIFARE™ Standalone Lock

Programming Operation;-

- 1. Initialisation:** There is a small button on the PCB in the front escutcheon. With the lock connected and the batteries in, press this for 3 seconds. There will be 3 beeps with a green light. All cards will be deleted including the owner card.
- 2. To program the owner card:** Offer the first card to the lock. There will be 3 beeps. There is only one owner card.
- 3. To program a user card:** Offer the owner card to the lock twice. There will be 1 beep and the green light will flash. While the green light is flashing you can offer new user cards to the lock. 1 beep means it has been accepted, 3 beeps means the capacity is full.
- 4. To delete a user card:** Offer the owner card to the lock twice. There will be 1 beep and the green light will flash. While the green light is flashing you can offer the card to be deleted. There will be 2 beeps with a red light. **N.B User Cards will only enrol with the deadbolt retracted. If the deadbolt is thrown the product will only allow a Owner Card to be programmed or allow for the unit to be Reset.**
- 5. To delete all user cards:** Offer the owner card to the lock 3 times. There will be 3 beeps.
- 6. To enable passage mode:** Turn the mechanical key all the way anti-clockwise and then return it to the insertion position. There will be one beep and the green light will be on. Offer the owner card. There will be 1 beep and the green light will go out.
- 7. To disable passage mode:** Turn the mechanical key all the way anti-clockwise and then return it to the insertion position. There will be one beep and the green light will be on. Offer the owner card. There will be 2 beeps and the green light will go out.
- 8. To set the lock to passage:** When in passage mode either 1. offer any card, there will be 1 beep and a green light offer any card or 2. throw and withdraw the dead bolt.
- 9. To lock the door from passage:** When in passage mode either 1. offer any card, there will be 2 beeps and a red light or 2. throw the dead bolt.

When the dead bolt is thrown the red light will flash every 3 seconds.
- 10. Low battery warning:** The lock will beep 8 times to indicate that the batteries need changing when operating the lock.
- 11. Illegal card alarm.** The lock will beep for 60 seconds if an un programmed card is offered 4 times.

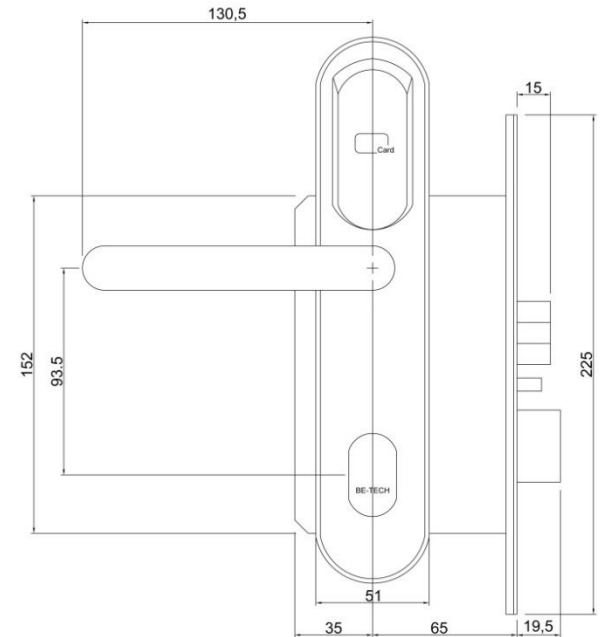

For further information contact:

Securefast plc
6, The Cedars Business Centre
Avon Road, Cannock
Staffordshire
WS11 1QJ



Call > +44 (0) 1704 502 801

Email > sales@securefast.co.uk

Visit > www.securefast.co.uk